

Newport Shopping Center

Waterfront Plaza, Newport VT



AVAILABLE FOR LEASE:

PLAZA SIZE: 86,782 +/- SF

SPACES FOR LEASE:

Suite 3: Up to 8,861 sf

Suite 9: Up to 9,630 sf

PRICE: \$10.00 sf NNN (\$3.31/sf)

Opportunity awaits in the historic and beautiful town of Newport, VT! Newport Plaza is conveniently located right off I91, in the heart of town. Less than 15 minutes from Canadian border, the plaza is heavily trafficked from both native and international tourists.

Current tenants include: Walgreens, Wendy's, Vista Foods, The Great Outdoors, Hoagies Pizza, The T Bar and more.



FOR MORE INFORMATION, CONTACT:

Kendra Kenney

O: 802 863 8218 | M: 508 479 8761 | kkenney@vermontrealestate.com

vermontrealestate.com

COMMERCIAL BROKERAGE | DEVELOPMENT | PROPERTY MANAGEMENT

Newport Shopping Center



Waterfront Plaza, Newport VT

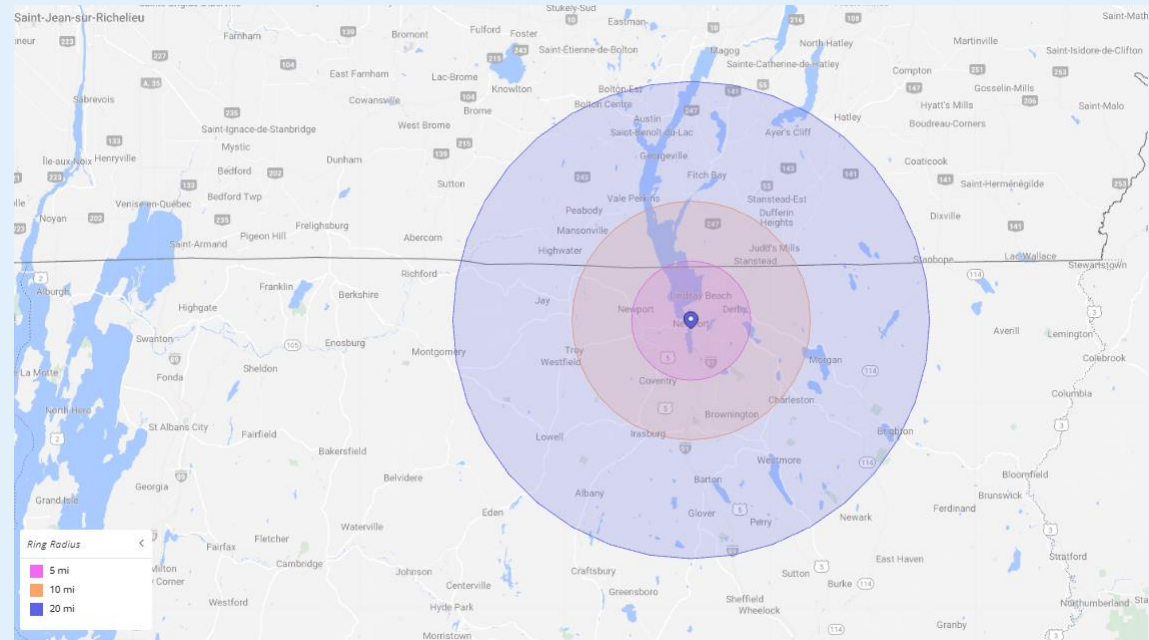

AVAILABLE FOR LEASE:

Traffic Count	 = 9,114
Avg Weekly Visits	4,217

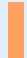

	 5 miles	 10 miles	 20 miles
Population	9,100	17,218	26,110
Households	3,799	7,267	11,210
Avg Household Income	\$61,945	\$57,861	\$57,676

*Information provided by  Placer.ai



FOR MORE INFORMATION, CONTACT:

Kendra Kenney

O: 802 863 8218 | M: 508 479 8761 | kkenney@vermontrealestate.com

vermontrealestate.com

COMMERCIAL BROKERAGE | DEVELOPMENT | PROPERTY MANAGEMENT

Photos:



FOR MORE INFORMATION, CONTACT:

Kendra Kenney

O: 802 863 8218 | M: 508 479 8761 | kkenney@vermontrealestate.com

vermontrealestate.com

COMMERCIAL BROKERAGE | DEVELOPMENT | PROPERTY MANAGEMENT

Newport Shopping Plaza

Newport, Vermont

POMERLEAU
REAL ESTATE

SITE PLAN:

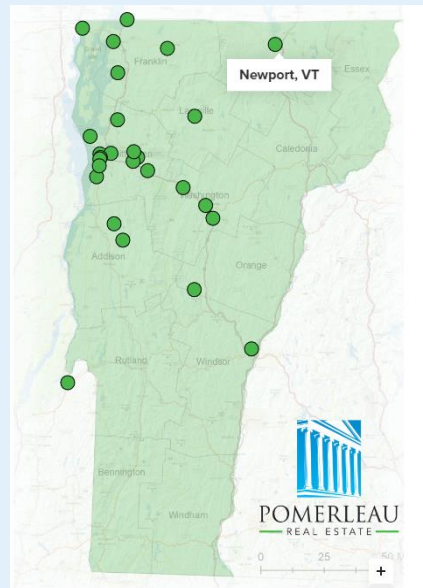

Pomerleau Real Estate
69 College Street
Burlington, VT 05401

In partnership with:



Information herein is believed to be accurate but is not warranted. All figures and information should be independently confirmed. This flyer is not a legally binding offer to sell or lease property. Please seek competent legal and financial advice. Pomerleau Real Estate represents the owner in this transaction.

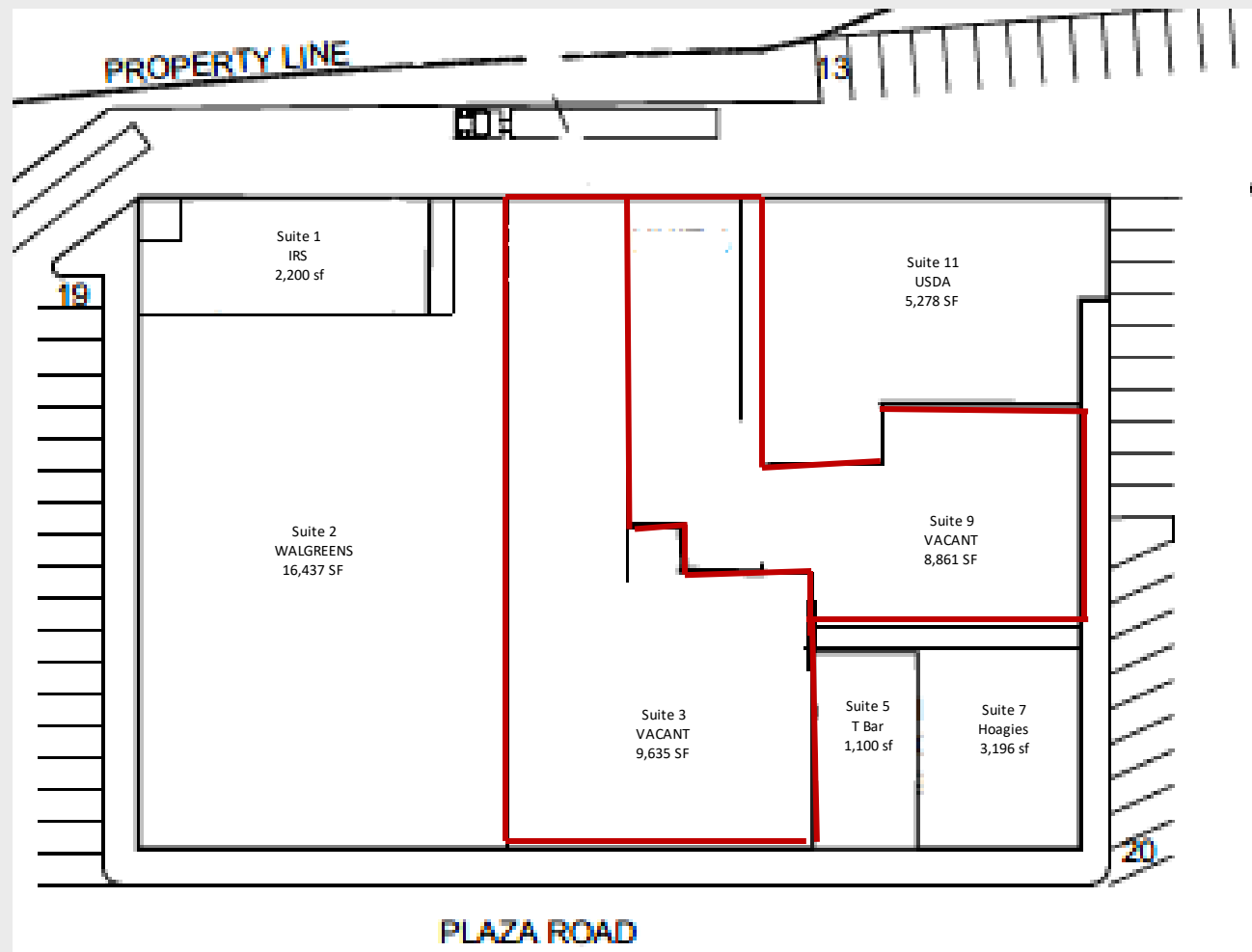

FOR MORE INFORMATION, CONTACT:

Kendra Kenney

O: 802 863 8218 | M: 508 479 8761 | kkenney@vermontrealestate.com

vermontrealestate.com

COMMERCIAL BROKERAGE | DEVELOPMENT | PROPERTY MANAGEMENT