

St Albans Shopping Plaza

St Albans, Vermont

POMERLEAU
REAL ESTATE



AVAILABLE FOR LEASE:

SIZE: 1,400 SF Retail
1,600 SF Retail
2,000 SF Warehouse

PRICE: \$10.00 - 12.00/SF NNN (\$3.19/SF)

Current tenants include:

- Danform Shoe's (*Our Newest Tenant!*)
- Rite Aid
- US Post Office
- Planet Fitness
- 14th Star Brewing Co.
- Dollar Tree
- Sherwin Williams
- Feldman's Bagels



FOR MORE INFORMATION, CONTACT:

Kendra Kenney

O: 802 863 8218 | M: 508 479 8761 | kkenney@vermontrealestate.com

vermontrealestate.com

COMMERCIAL BROKERAGE | DEVELOPMENT | PROPERTY MANAGEMENT

St Albans Shopping Plaza

St Albans, Vermont

Suite 19A:

1,400 +/- SF

Formerly used as a hair salon

Suite 19B:

2,000 +/- SF

Use: Storage

Suite 9:

1,600 +/- SF

Use: Retail

To set up a showing, call

or email Kendra Kenney.

Pomerleau Real Estate

69 College Street
Burlington, VT 05401

In partnership with:



Information herein is believed to be accurate but is not warranted. All figures and information should be independently confirmed. This flyer is not a legally binding offer to sell or lease property. Please seek competent legal and financial advice. Pomerleau Real Estate represents the owner in this transaction.

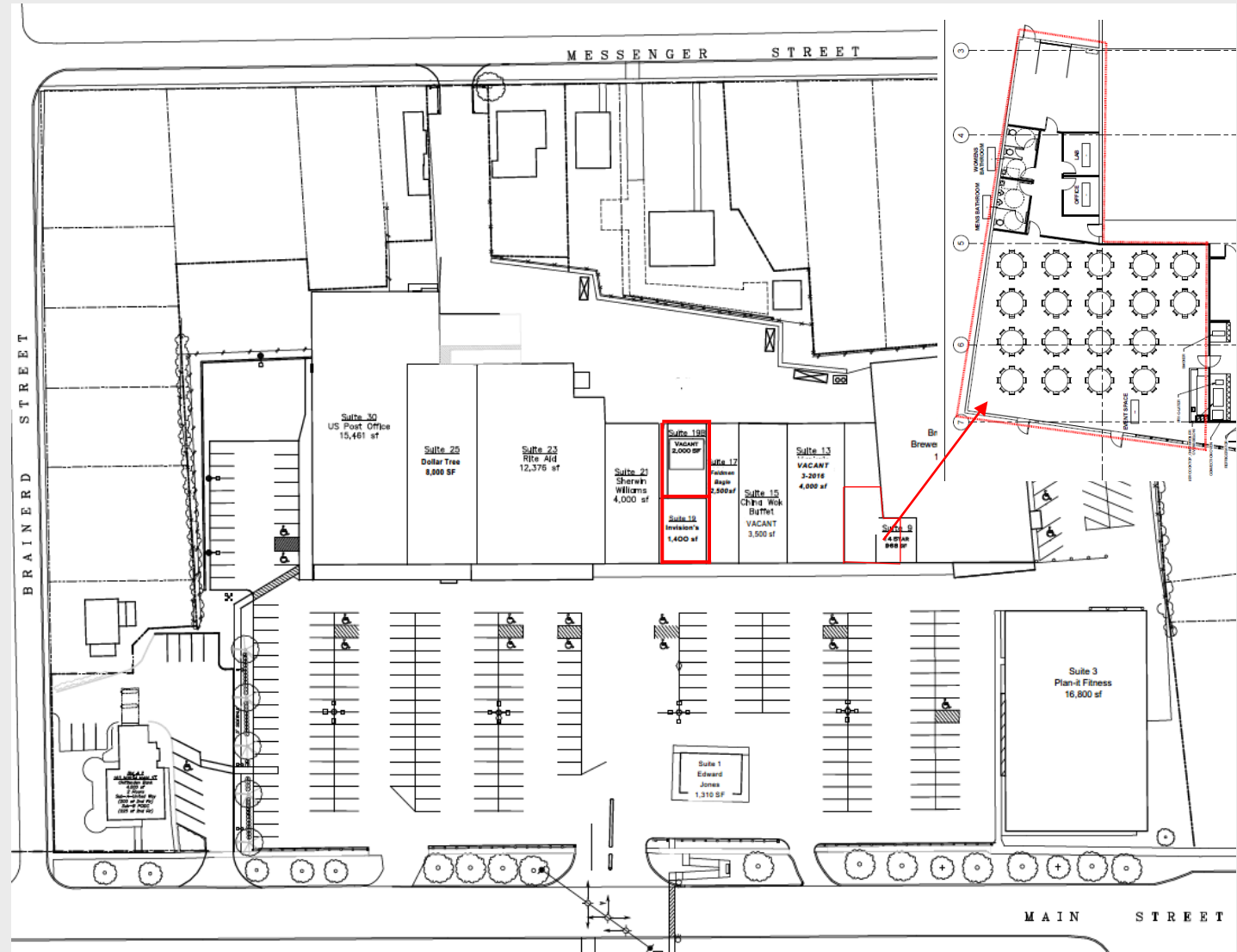

FOR MORE INFORMATION, CONTACT:

Kendra Kenney

O: 802 863 8218 | M: 508 479 8761 | kkenney@vermontrealestate.com

vermontrealestate.com

COMMERCIAL BROKERAGE | DEVELOPMENT | PROPERTY MANAGEMENT